

## INSTALLATION INSTRUCTIONS

### WhereTag Reference Tag Assembly Parts Kit:

- A. WhereTag (2 Ordered Separately)
- B. WhereTag Snap-on Mount Ring (2 Ordered Separately)
- 1. These Field Assembly Instructions (1)
- 2. Bracket, Reference Tag (1)
- 3. Bracket, Mounting Arm (1)
- 4. ¼-20 X ¾ inch Stainless Steel Bolts (2)
- 5. ¼ inch Stainless Steel Split Ring Lock Washer (2)
- 6. ¼ inch Stainless Steel Flat Washer (2)
- 7. 8-32 SS Hex Nylock Nut (4)
- 8. 8-32 SS Pan Head Phillips Screw (4)
- 9. For Detailed Installation Instructions see WhereNet PN D1394 Reference Tag Assembly, Installation, and Placement Guide

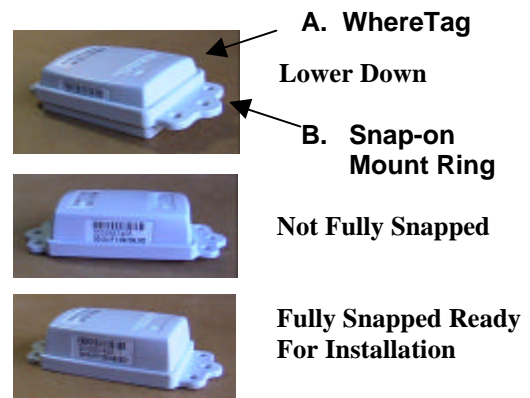

FIG. 1

### Installation Procedure

<b>Step 1</b> <b>Fig. 1</b>	Assemble Snap on Mount Ring (B) to WhereTag (A) Seating ring fully.
<b>Step 2</b> <b>Fig. 2</b>	Use 2 Pan Head Phillips 8-32 SS Screws (8) and 2 Hex Nylock 8-32 SS Nuts (7) to attach the Tag with Mounting Ring to the Reference Tag Bracket (2): see Fig. 2.
<b>Step 3</b> <b>Fig. 3</b>	Check WhereTag Orientation against Fig. 3.
<b>See Other Side of this Document</b>	When mounting to a wall or pole, assemble the mounting arm to the tag bracket using the supplied hardware: see Fig. 4.
<b>Step 4</b> <b>Fig. 4</b>	Insert the ¼-20 bolts through the split washer and the flat washer. Place the tag bracket over the mounting arm and thread the ¼-20 bolts to the nut inserts in the mounting arm.
<b>Step 5</b> <b>Fig. 5</b>	Mount the assembled brackets to the pole or flat vertical surface and use appropriate hardware. See Fig. 5.  If mounting to a horizontal surface such as a ceiling or overhang, use the mounting holes at the top of the tag bracket and appropriate hardware, and discard the mounting arm.

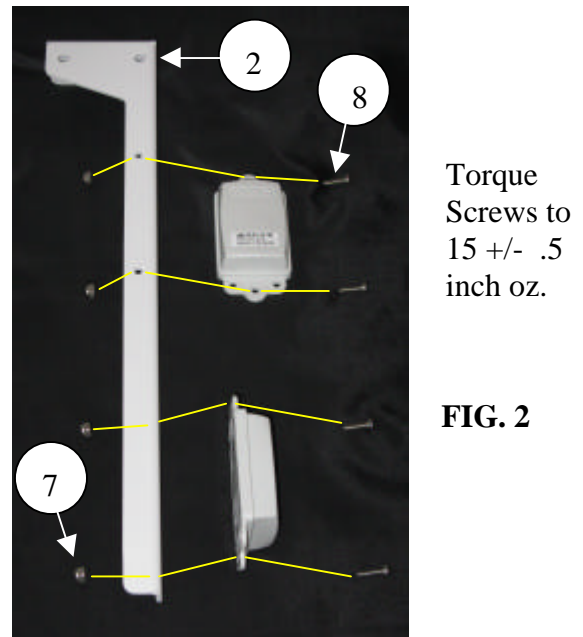
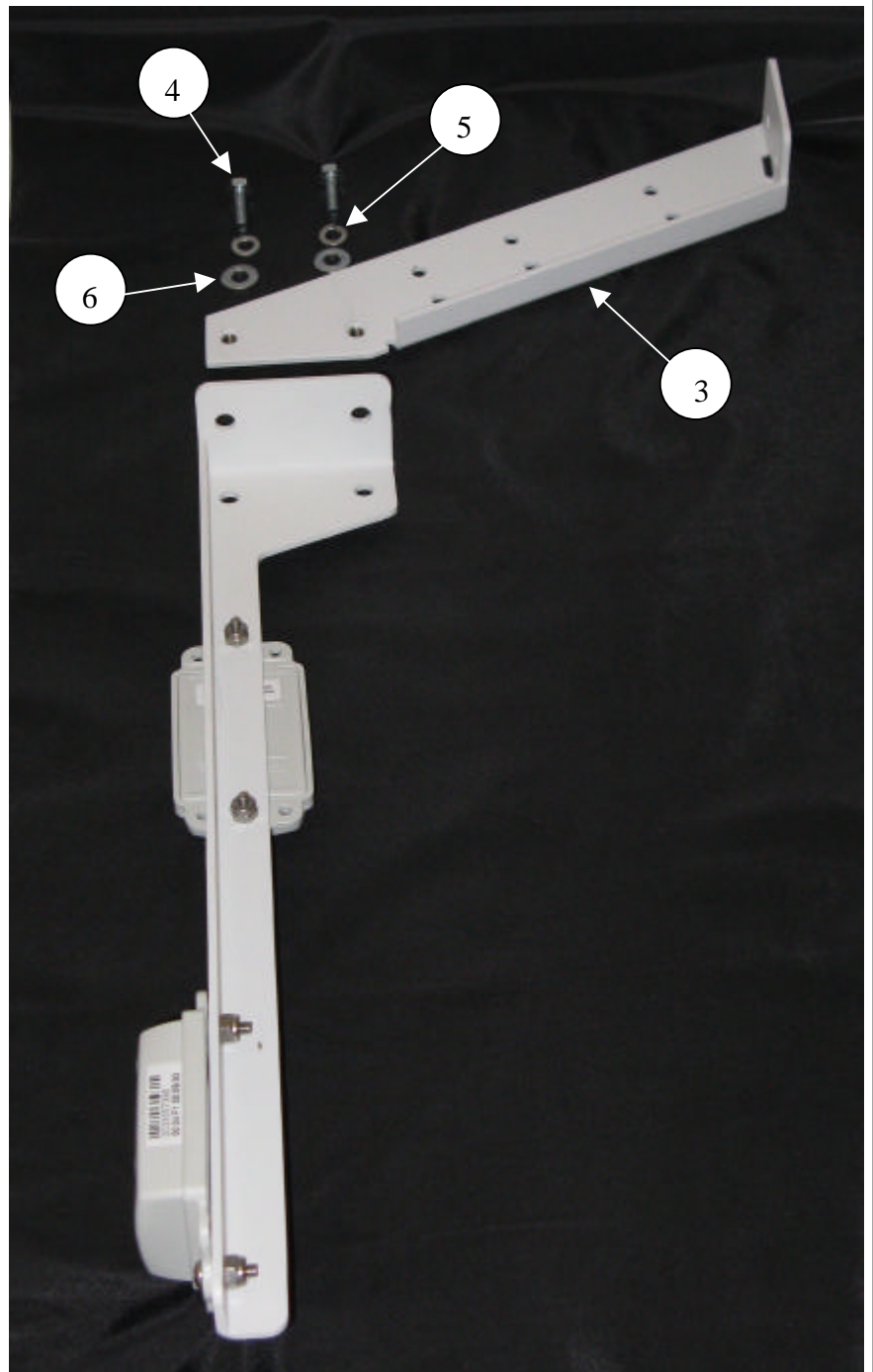

FIG. 2



FIG. 3

Torque  
Bolts to  
65 +/- 3  
inch oz.



**FIG. 4**



**FIG. 5**

**Reference Tag  
Mounted to Pole**