

ZD421

Ribbon Cartridge Desktop Printer



IMPORTANT

Go to zebra.com/zd421c-info and install the driver for your printer.

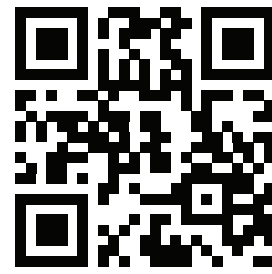

The driver **MUST** be installed before connecting the printer to the computer, or it will cause complications. If your Microsoft Windows-based computer does not have the driver installed for this printer, download it from zebra.com/zd421c-info and install it before continuing.

After unpacking, make sure you have all items shown below.



Printer



Quick Start Guide



USB Cable



Power Cord



Power Supply

! Labels and the ribbon cartridge are not included.

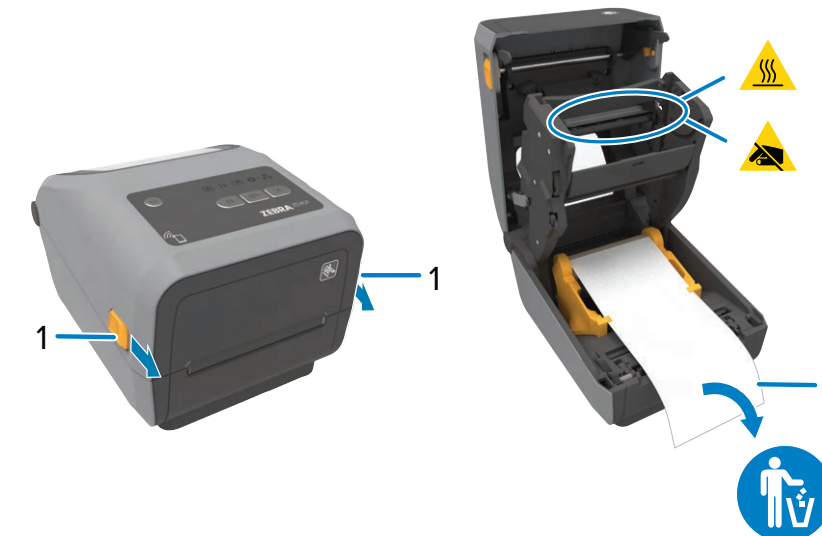
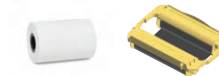

Slide the release latches (1) to the front to unlock the cover.

Open the printer and remove the packing (1).



Quick Start Guide

③ Load Media



Unroll (1) and discard (2) the outer layer of the media roll (3).

Spread the roll holders open (1) and place the roll (2) into the printer.

Verify the roll spins easily on the holder.

Pull the end of the roll past the front edge of the printer.

Press the media under the guides (1).

④ Adjust Sensor



Align the sensor to the center of the roll for regular labels (1).

⑤ Adjust Sensor (continued)



Align the sensor to the edge of the roll for marked labels (1).

⑥ Load Cartridge



Insert the ribbon cartridge (1).

Press down until the cartridge clicks into place.

⑦ Close Printer



Push down on the front edge of the printer until it locks.

⑧ Connect Power

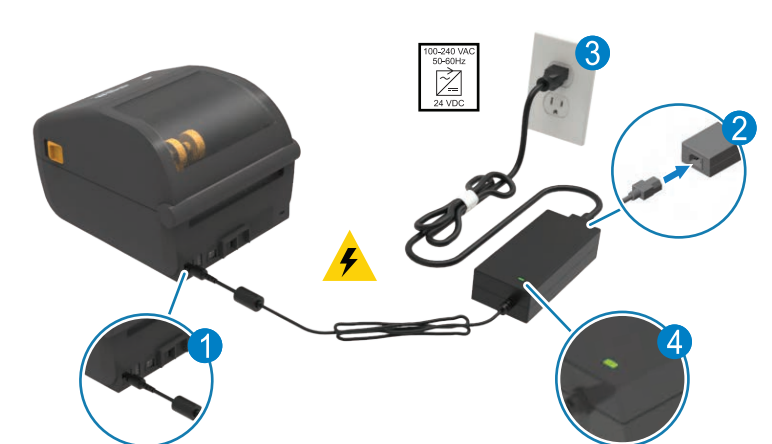

1. Plug the power supply into the printer.
2. Plug the power cable into the power supply.
3. Plug the power cord into an appropriate receptacle.
4. Verify that the power supply lights green.

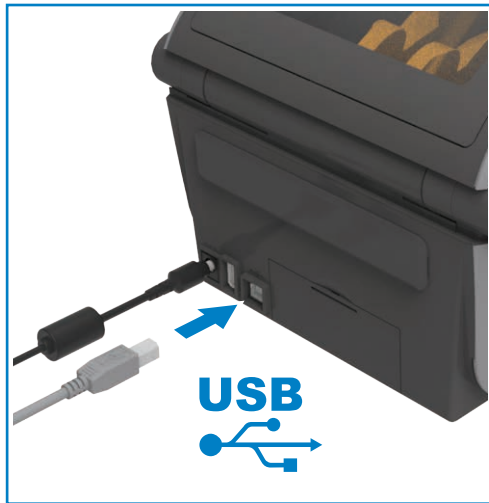

1. Connect a USB cable to the printer.
2. Connect the other end to your printer.



Press **POWER** (1).



When the printer is ready, the printer status light turns green (1).

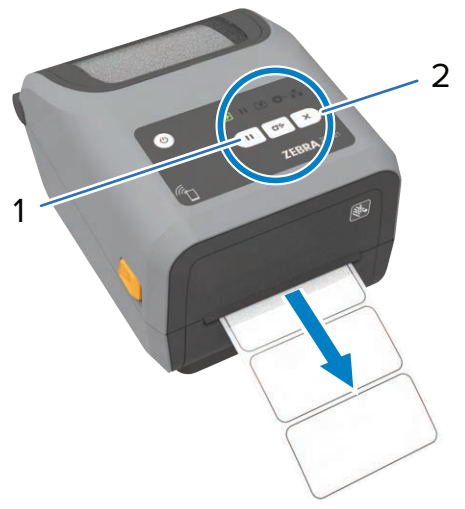

Press and hold **PAUSE** (1) + **CANCEL** (2) for two seconds to line up the labels.



Press and hold **FEED** (1) + **CANCEL** (2) for two seconds to print a configuration report.



When the media runs out, the printer status and media status lights turn red (1).





















Open the printer and discard the empty roll (1).



Clean the printhead (1) with a cleaning pen (2). Clean from the middle to the outside. Do not use a cleaning pen on the platen.



Zebra Technologies | 3 Overlook Point | Lincolnshire, IL 60069 USA zebra.com
ZEBRA and the stylized Zebra head are trademarks of Zebra Technologies Corp., registered in many jurisdictions worldwide. All other trademarks are the property of their respective owners. © 2023 Zebra Technologies Corp. and/or its affiliates. All rights reserved.

  View user documentation. zebra.com/zd421c-info	 View Quick Answers and Knowledge Base. zebra.com/knowledge	
  Need to design a label? zebra.com/zebradesigner	 Join Community Connection of Zebra users and ambassadors. zebra.com/supportcommunity	
  Learn about genuine Zebra supplies. zebra.com/supplies	 Contact Zebra about your printer. zebra.com/contactsupport	
  Need to manage your printer? zebra.com/profilemanager	 Need to secure your printer? zebra.com/printsecure	
 Learn about product patent information. ip.zebra.com		



When the ribbon runs out, the printer status and ribbon status lights turn red (1).



Open the printer and discard the empty cartridge (1).