

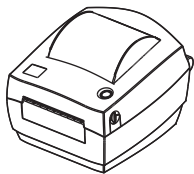

ZD120



1



Download and Install Windows Driver

<http://www.zebra.com/zd120-info>

2



Setup Your Printer

<http://www.zebra.com/zd120-info>

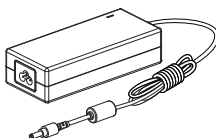
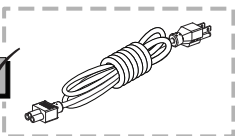
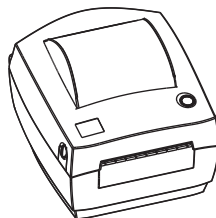
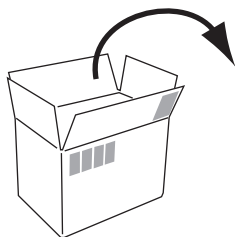

P1099713-002

3

Connect Power

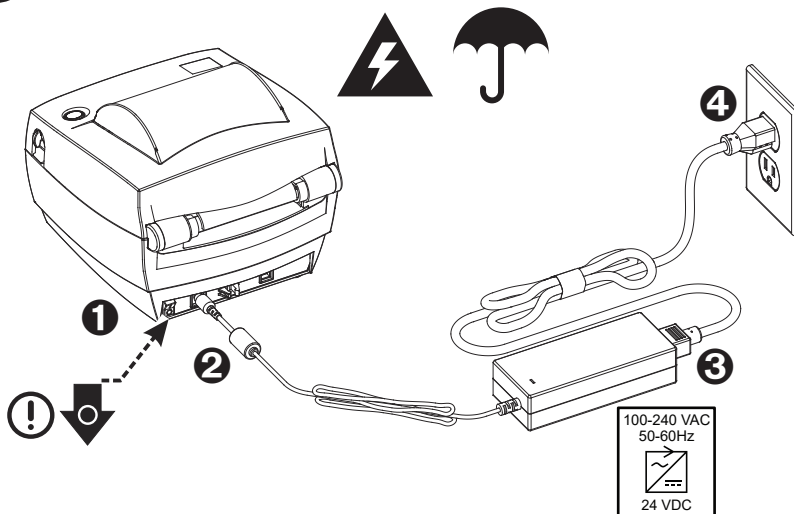

4

Connect Interface

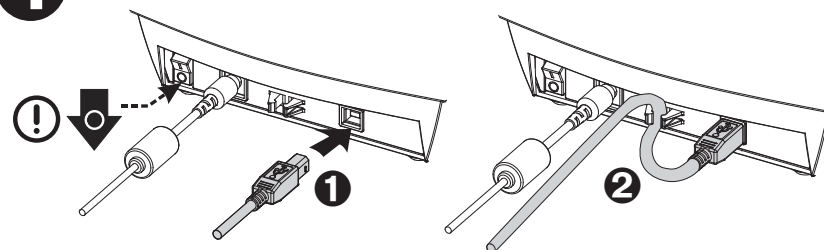

5

Power On

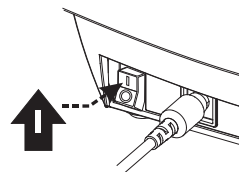

6



Register For Support

<http://www.zebra.com/register>

Load Media

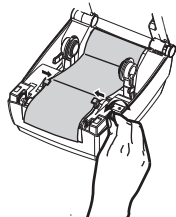
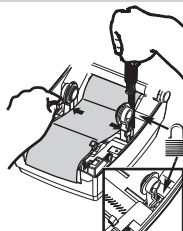
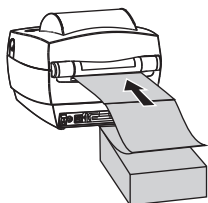
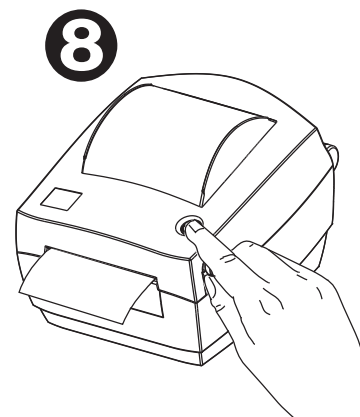
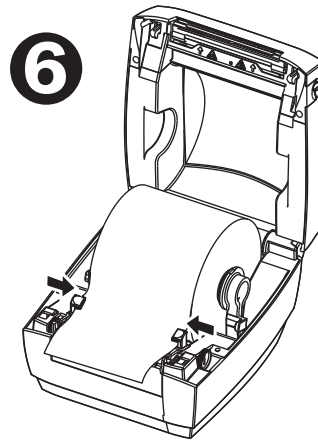
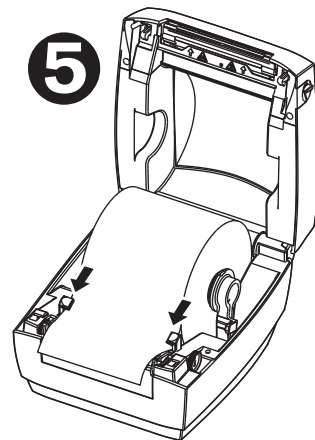
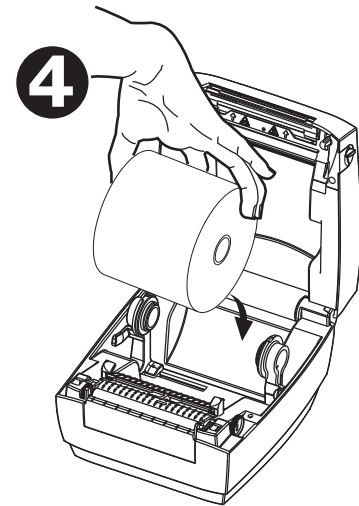
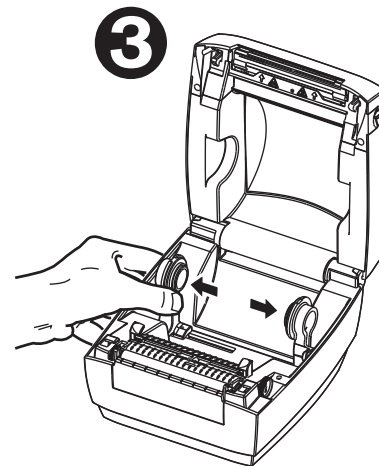
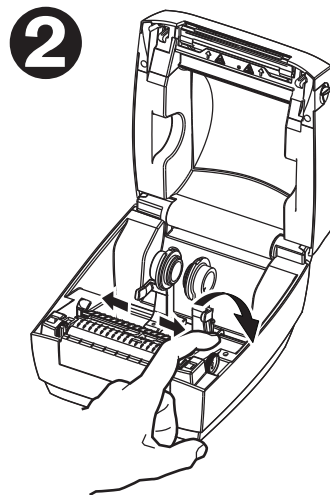
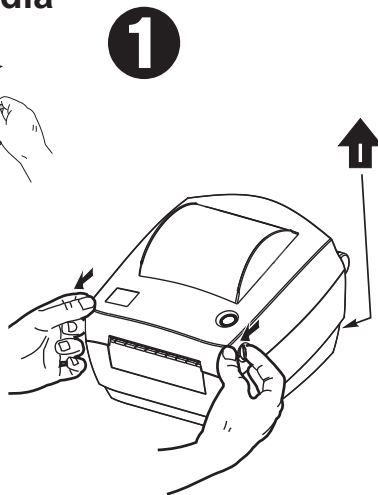
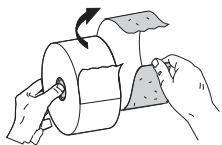

Learn About Genuine Zebra Supplies

<http://www.zebra.com/supplies>



www.zebra.com/zd120-info



<http://www.zebra.com/locations>

NA and Corporate Headquarters
+1 800 423 0442
inquiry4@zebra.com

Asia-Pacific Headquarters
+65 6858 0722
contact.apac@zebra.com

EMEA Headquarters
zebra.com/locations
mseurope@zebra.com

Latin America Headquarters
+1 847 955 2283
la.contactme@zebra.com

©2018 ZIH Corp. and/or its affiliates. All rights reserved. Zebra and the stylized Zebra head are trademarks of ZIH Corp., registered in many jurisdictions worldwide. All other trademarks are the property of their respective owners.